

# MULTI ROLLING CODE REMOTE CONTROL INSTRUCTION

The model we design can compatible with 12 popular brands in the world.

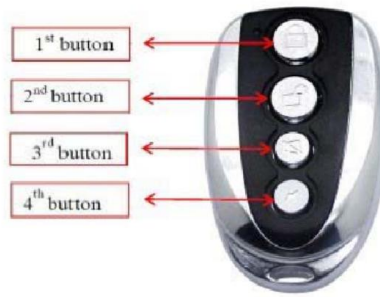

The programming way as below:

1) Enter programming mode.

Pressing 1<sup>st</sup> button and 2<sup>nd</sup> Button at the same time until led begin to flash, then release buttons.

2) Select Brand and programming

Pressing the programmed button and check how many times for the led flashes. For example, if the led flash twice, it is BFT coding. If the brand is what you want, confirm by press the 3<sup>rd</sup> button and 4<sup>th</sup> button at the same time until the led flashes, then release buttons.

3) Programming 4 brands at the same time

First, Enter the programming mode as Point 1, choose every button for different brands. Second, pressing buttons 3<sup>rd</sup> and 4<sup>th</sup> at the same time to complete the programming.

Buttons can be reprogrammed to different brands at any time as you want.

4) Fastest programming way for BFT brand remote.

Pressing 1<sup>st</sup> button and 4<sup>th</sup> button at the same time to finish the programming.

Remarks:

1) For the remote, you can select 12 brands on each button and each button can be different brands.

2) Every time you select the brand, confirmed by closing the programming.

3) To reset, Pressing the 3<sup>rd</sup> and 4<sup>th</sup> buttons at the same time for more than 7 seconds, then you will see the Led flash faster than normal.

## Compatibility Panel

Led flash times	Brand	Led flash times	Brand
1 times short	1. Nice-Smilo 	2 times short	2. BFT 
3 times short	3. Beninca Allmatic 	4 times short	4. DEA 
5 times short	5. ERREKA Standard 	6 times short	6. GBD 

7 times short	7. FOX 	8 times short	8. PUJOL VARIO 
9 times short	9. FAAC 433MHZ 	10 times short	10. MUTANTCODE 
11. 1 times long & 1 times	Doorhan, Novoferm, skymaster 	12. 1 times long & 2 times	12. Aprimatic 